

APPROVAL

TO: Altice/Suddenlink

DATE 10-22-2020

FILED
TERRY ROSS
COUNTY CLERK
2020 OCT 30 AM 11:01
BY [Signature]
UPSHUR COUNTY

The Upshur County Commissioners Court offers no objections to the location on the right-of-way of your proposed catv line across Locust, Emma Oaks & Green Road as shown by accompanying drawings and notice dated 10-22-2020, except as noted below:

N/A

It is expressly understood that the Upshur County Commissioners Court does not purport, hereby, to grant and right, claim, title, or easement in or upon this county road; and it is further understood that in the future should for any reason Upshur County need to work, improve, relocate, widen, increase add to or any manner change the structure of this right-of-way line, this line, if affected, will be moved under the direction of the Upshur County Engineer and shall be relocated at the complete expense of the owner. Upshur County shall be notified a minimum of 48 hours prior to the beginning of any work.

All work on the county right-of-way shall be performed in accordance with the County Engineer's instructions. The installation shall not damage any part of the highway and adequate provisions must be made to cause minimum inconvenience to traffic and adjacent property owners. Special specifications for placing this line are as follows:

1. All ground lines are to be installed a minimum of 36 inches below the flowline of the adjacent drainage or borrow ditch.
2. All excavations within the right-of-way and not under surfacing shall be backfilled by tamping in 6 inch horizontal layers. All surplus material shall be removed from the right-of-way and the excavation finished flush with surrounding natural ground.
3. Lines crossing under surfaced roads and under surfaced cross roads within the right-of-way shall be placed by boring. Boring shall extend from crown line to crown line.
4. All lines under roads carrying pressure in excess of 50 psi shall be enclosed in satisfactory casing extending from right-of-way line to right-of-way line. Pipe used for casing may be of any type approved by the County Engineer and shall be capable of supporting the load of roadbed and traffic and shall be so constructed that there will be no leakage of any matter through the casing for its entire length. Inside diameter of casing shall be at least 2 inches greater than the largest outside diameter of carrier pipe, joint or couplings. (Encasement is not required on lines installed 48 inches or greater below flowline.)
5. All lines, where practicable, shall be located to cross roadbed at approximately right angles thereto. No lines are to be installed under or within 50 feet of either end of a bridge unless approved by the County Engineer in writing. No lines shall be placed inside any culvert or within 10 feet of the closest point of same.
6. Parallel lines will be installed as near the right-of-way lines as is possible and no parallel line will be installed in the roadbed or between the drainage ditch and roadbed unless approved by the County Engineer in writing.
7. Overhead lines will have a minimum clearance of 18 feet above the road surface at point of crossing.
8. Operations along roadways shall be performed in such a manner that all excavated material be kept off the pavements at all times, as well as all operating equipment and materials. Do not use equipment or installation procedures which will damage any road surface or structure. The cost of any repairs to road surfaces, roadbed, structures or other right-of-way features as direct result of this installation will be borne by the owner of this line.
9. Barricades, warning signs, lights and flagmen, when necessary, shall be provided by the contractor or owner. One half of the traveled portion of the road must be open to traffic at all times. All traffic control shall be in accordance with the requirements of the current version of the Texas MUTCD.
10. Utility company shall install adequate erosion control measures for any excavation work being performed.

APPROVED:

[Signature]
Road Administrator

APPROVED:

[Signature]
Chairperson, Upshur County Commissioners Court
Revised 11/30/10

**NOTICE OF PROPOSED INSTALLATION
PIPE AND/OR UTILITY LINES**

**TO: UPSHUR COUNTY COMMISSIONERS COURT
c/o UPSHUR COUNTY ENGINEER
UPSHUR COUNTY ROAD & BRIDGE DEPARTMENT
P. O. BOX 730
Gilmer, TX 75644**

DATE: 10/21/2020

EXPIRES: _____

Formal notice is hereby given that Altice/Suddenlink proposes to bore a catv line within the right-of-way of Locust Rd, Emma Oaks and Green rd as follows:

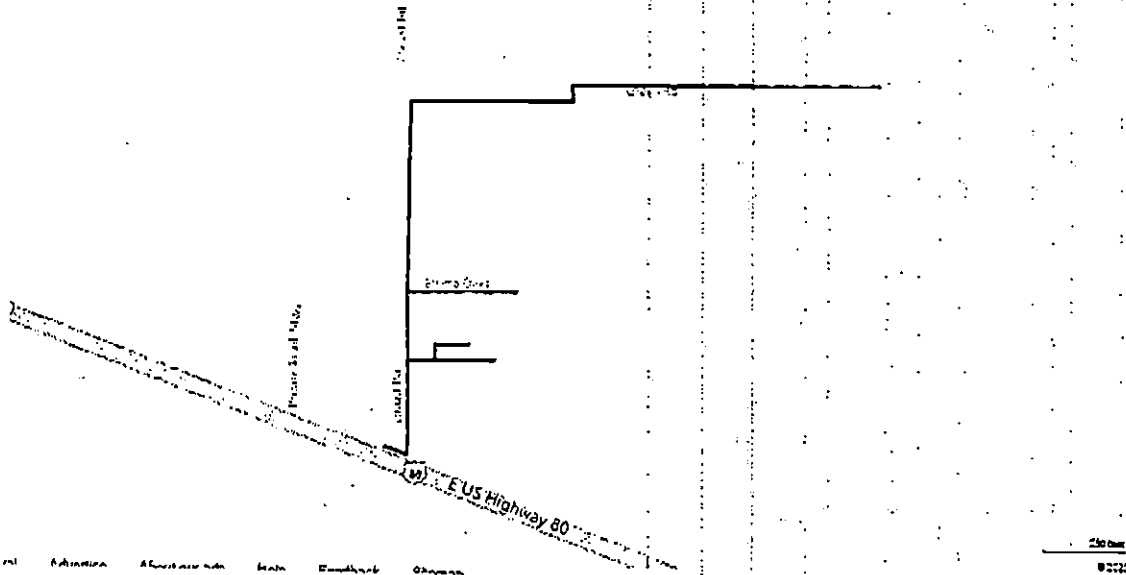

The location and description of the proposed line and appurtenances is more fully shown by three copies of drawings attached to this notice. The line will be constructed and maintained on the County right-of-way as directed by the County Engineer in accordance with current Upshur County specifications.

Construction of this line will begin on or after the 23 day of November, 2020 and will be completed within 90 days of the date of approval.

Firm _____ Meridium Group for Altice/Suddenlink
By _____ Joe Almanza 903-238-4924
Title _____ Digital Services Engineer
Address _____

- NOTE:**
1. This form to be submitted in triplicate for each proposed installation.
 2. The permit shall be in effect until the utility line is removed from the right of way.
 3. Inform the County Engineer if work is not completed within this time.

